

# CONTOUR RAIL



### Compact and attractive hanging system

"Less rail, more art". Contour Rail gets the job done in spite of its minimal dimensions, and has an attractive, sleek design. Hanging pictures, or hanging and moving framed photos is easy thanks to the Contour Rail. Using the clips, the picture rails may be mounted to the wall (minimum distance from the ceiling: 15 mm). In addition to the aluminium version of the rail, the available model in white may be painted in any colour. The refined style of the 1 mm Twister hanging wires with Micro Grip 1 mm suspension hook make them a perfect match for the compact shape of this hanging system.

### RAIL



CONTOUR RAIL - WHITE PRIMER RAL 9016

END CAP

200 cm P/1\*

300 cm P/1\*

WHITE

ARTICLE NO. 30.11201

30.11301

30.31210

### FASTENER KIT WHITE

ARTICLE NO. 30.31310

30.31330

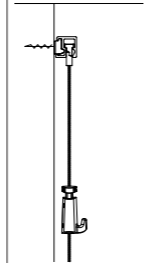
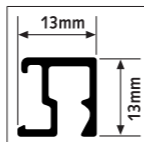

**20**  
KG/M

**10**  
YEAR  
WARRANTY

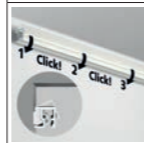

3 CLIPS / M

# CONTOUR RAIL GLUED



### Contour Rail glued - hanging without drilling

Looking for a compact hanging rail that 'disappears' in a room? Contour Rail offers the solution: the rail can also be mounted to the ceiling using glue. Thanks to the special design, the glue may be applied in and on the profile in the desired manner. When the Contour Rail is glued and painted in the same colour as the wall, it becomes inconspicuous while still offering all the advantages of a flexible hanging system: the ability to hang and move pictures without damaging the walls.

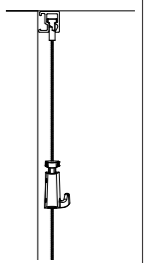
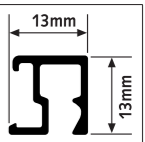

**10**  
KG/M

**10**  
YEAR  
WARRANTY

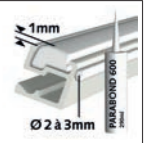

### RAIL



CONTOUR RAIL - WHITE PRIMER RAL 9016

END CAP

200 cm P/1\*

300 cm P/1\*

WHITE

ARTICLE NO. 30.11201

30.11301

30.31210

### FASTENER MATERIAL



CONTOUR RAIL GLUE SET (FOR FIXATION OF 4,5-5M)

3M SURFACE CLEANERS & GLUE PARABOND 600 WHITE 290 ML

ARTICLE NO.

30.31180

\* P/1: PACKAGED BY THE PIECE IN FOIL



installation video

### CONTENT FASTENER KIT

			QUANTITY 200 cm	QUANTITY 300 cm
	30.31110	CLICK&CONNECT	6x	9x
	9.4929	SCREW	6x	9x
	9.4931	PLUG	6x	9x
	30.31210 (WHITE)	END CAP	2x	2x
	2388	INSTRUCTION	1x	1x

ALL MOUNTING MATERIAL MAY BE ORDERED SEPARATELY. SEE OVERVIEW ON PAGE 40  
\* P/1: PACKAGED BY THE PIECE IN FOIL