

# HANGING WHITEBOARDS

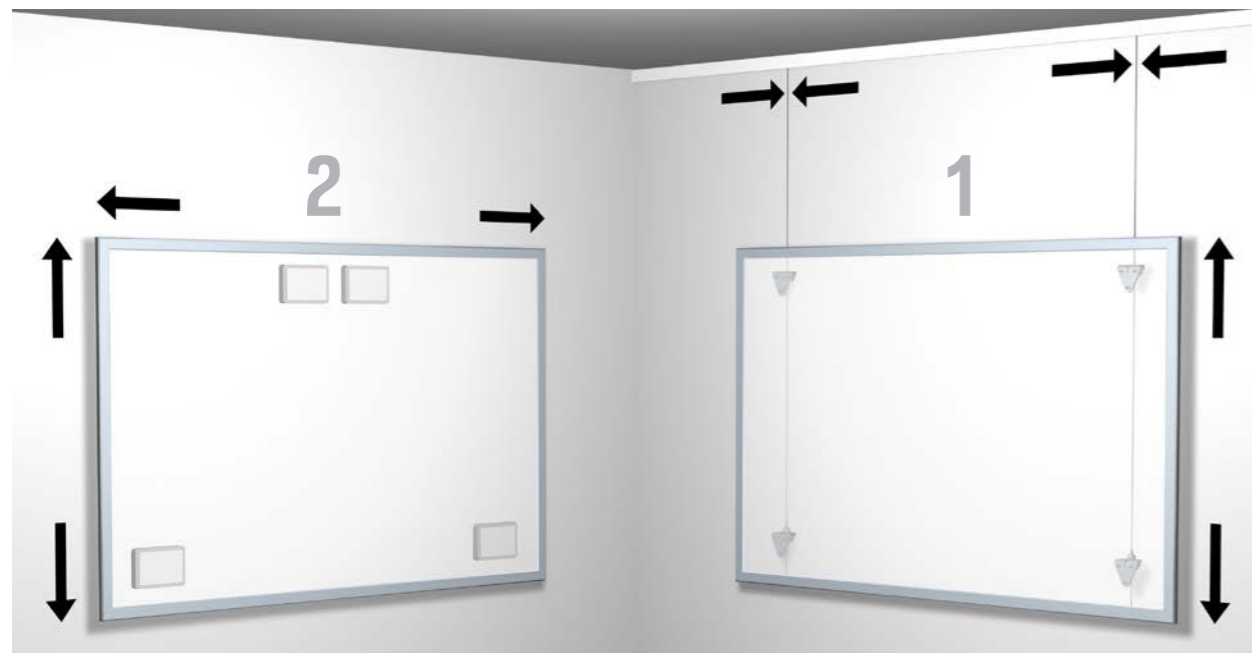

There are a variety of ways to hang a whiteboard on the wall. Hanging a whiteboard with the aid of the Whiteboardset offers the option of repositioning the whiteboard either horizontally or vertically. The Artiteq Whiteboardset has been designed to make it easy to hang a whiteboard on the wall, and offers flexibility since it may be used in combination with our hanging rails. The clamps ensure a stable mounting of the whiteboard to the wall. By combining the Whiteboardset with the hanging rail, it is extremely easy to mount the whiteboard to the precise desired spot.

# WHITEBOARDSET / HANGING MAGNET FOR WHITEBOARDS



MAX  
**30**  
KG/M

**10**  
YEAR  
WARRANTY

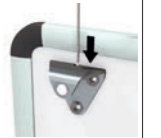

## WHITEBOARDSET



WHITEBOARDSET  
(HANGING WIRE  
NOT INCLUDED)\*

CLAMP UP

CLAMP DOWN

SCREW 10 mm

ARTICLE NO. 9.4550

CAN BE USED IN COMBINATION WITH ALL ARTITEQ PICTURE HANGING SYSTEMS  
\* TO BE USED WITH TWISTER 2 mm STEELWIRE (SEE PAGE 62)

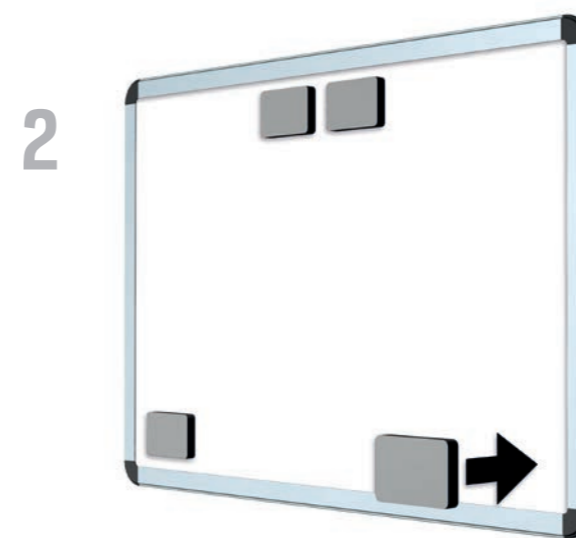

## SELF-ADHESIVE HANGING MAGNET FOR WHITEBOARDS

7430.001

SELF-ADHESIVE HANGING MAGNET FOR WHITEBOARDS

75 x 50 x 11 mm

MAX. 3 kg